

L'Agora di Atene

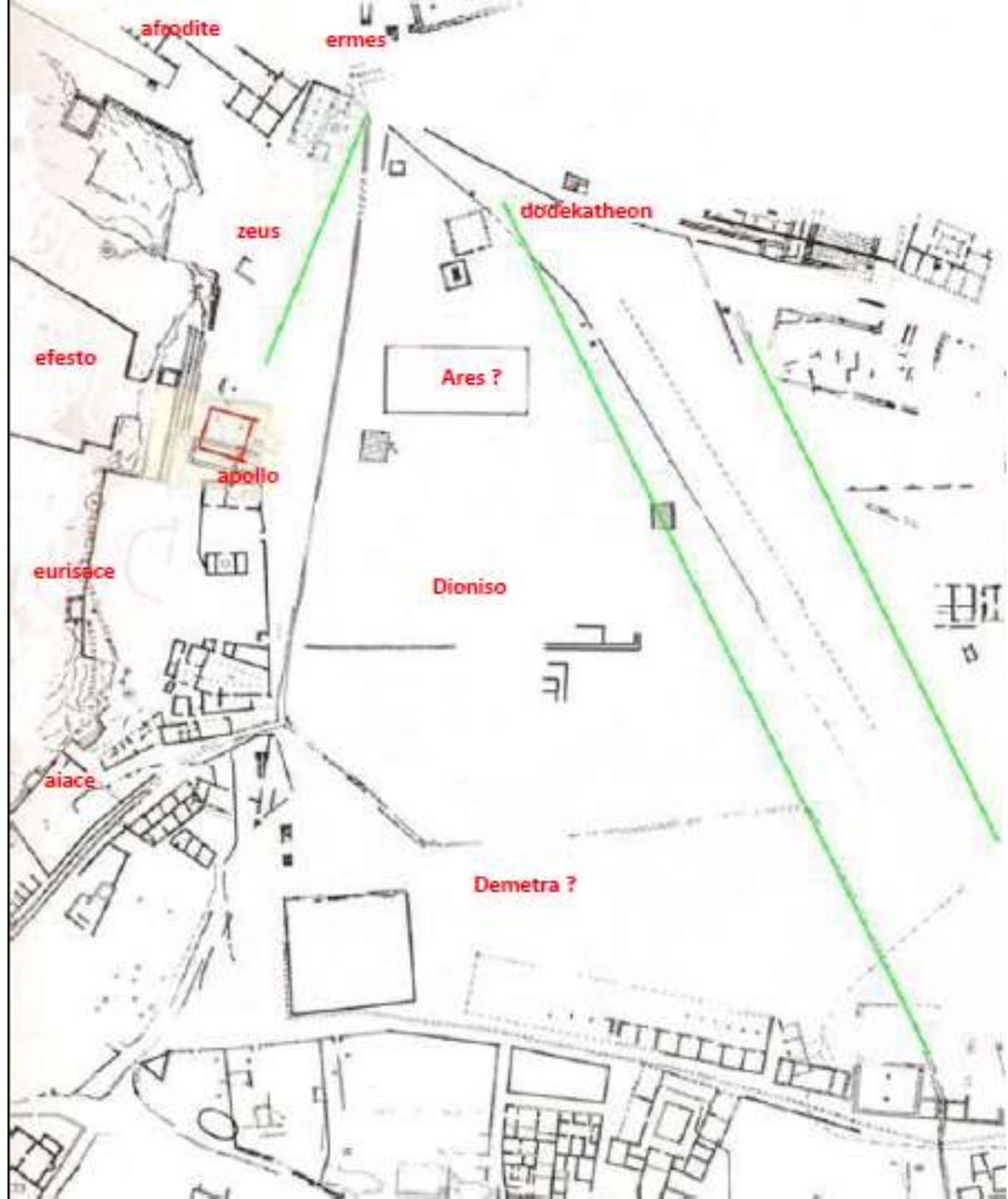

Selezione di immagini e mappe

**Agora di epoca
arcaica con
indicazione dei
culti praticati**



AGORA

c. 500 B.C.



0 50 100 M

J. TRAVL 1974

L'agorà del
Ceramico:
planimetria della
fase di V sec.
a.C.

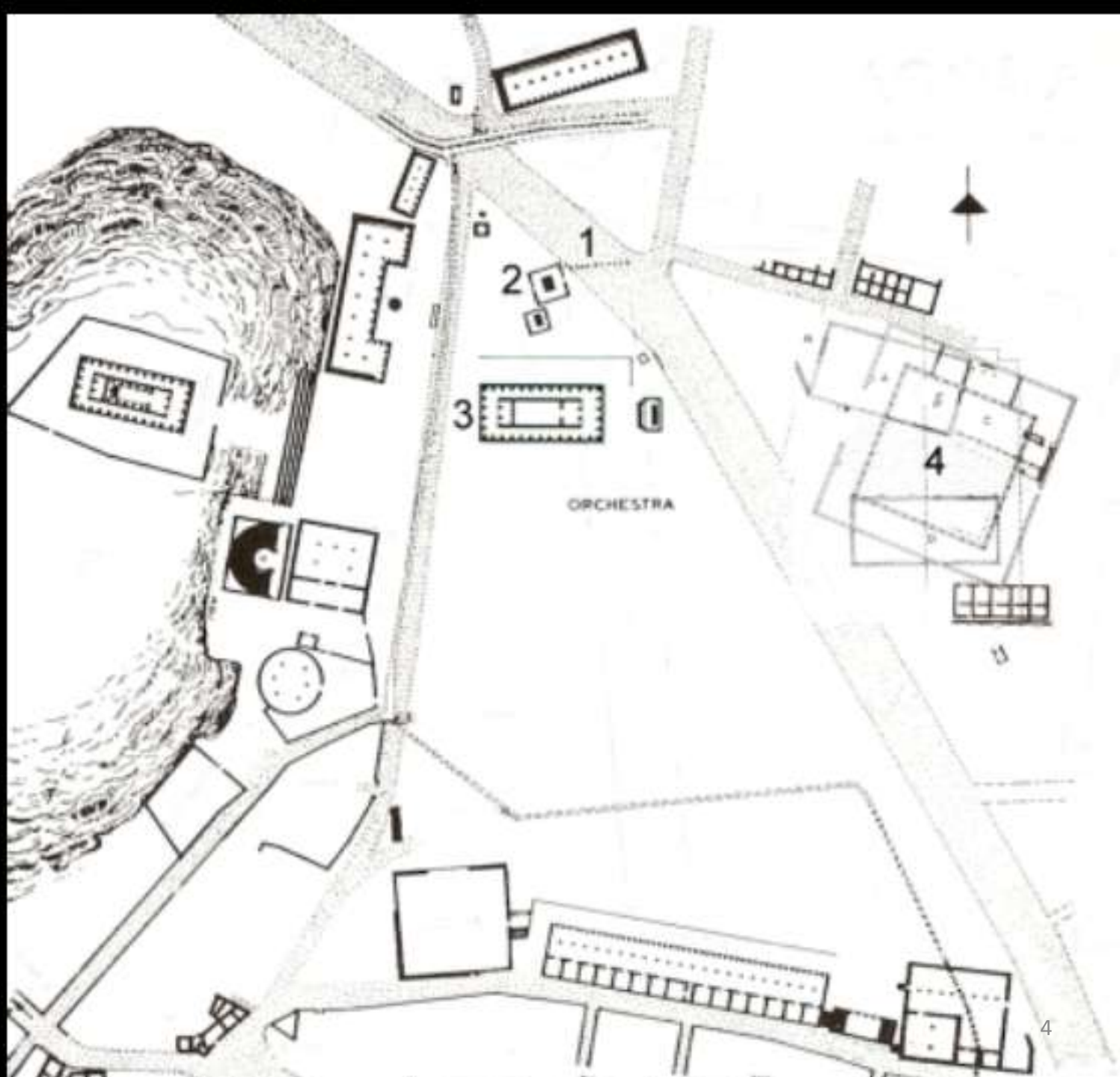

AGORA

II CENT. B.C.

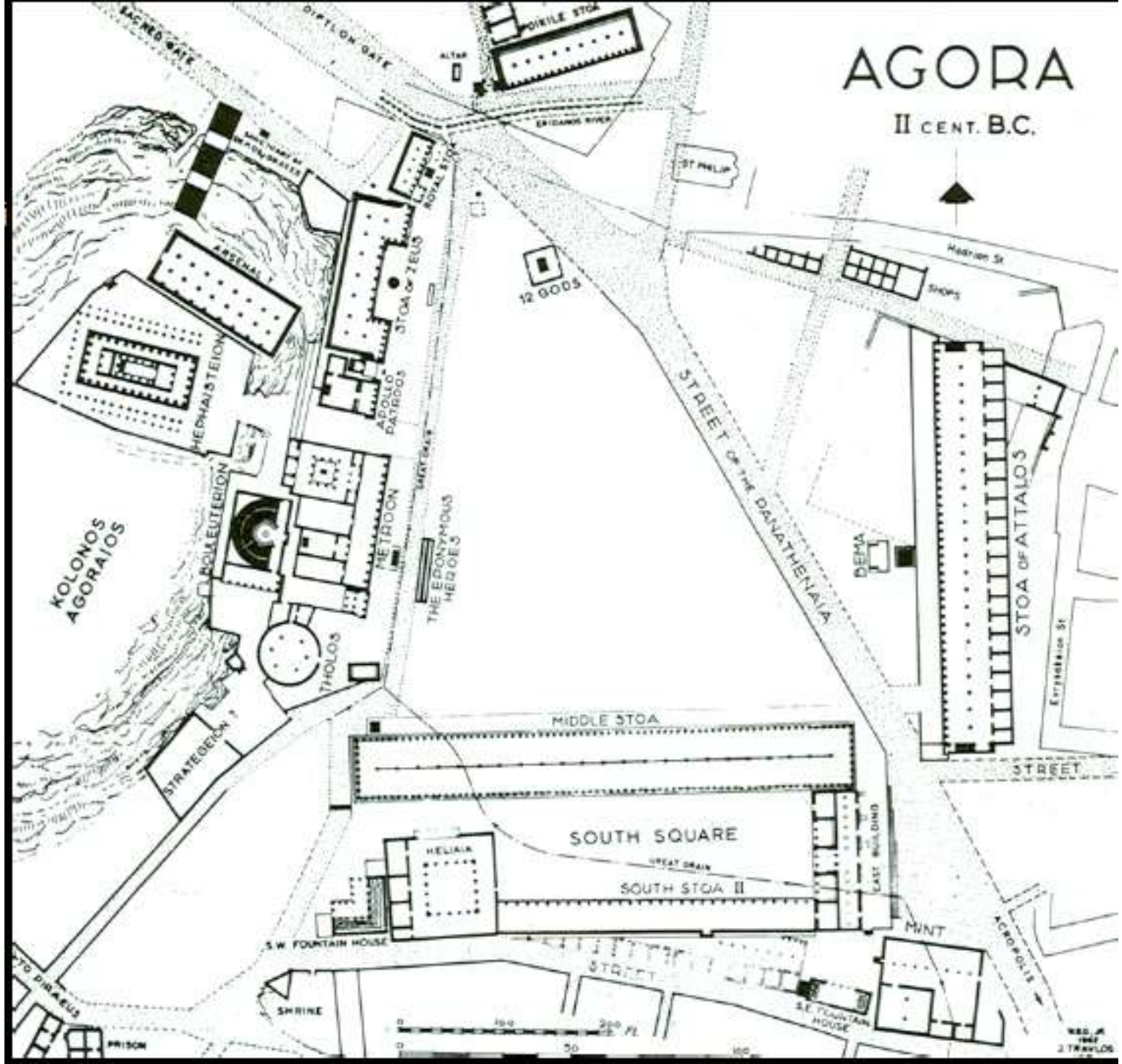



L'agorà del Ceramico: planimetria della fase monumentale finale, intorno al II sec. d.C. In verde gli edifici arcaici; in azzurro quelli classici; in arancione quelli di II sec. a.C.; in rosso gli interventi romanoimperiali

Atene, l'agorà del Ceramico: il lato occidentale, veduta del Kolonòs Agoraios e del tempio di Efesto

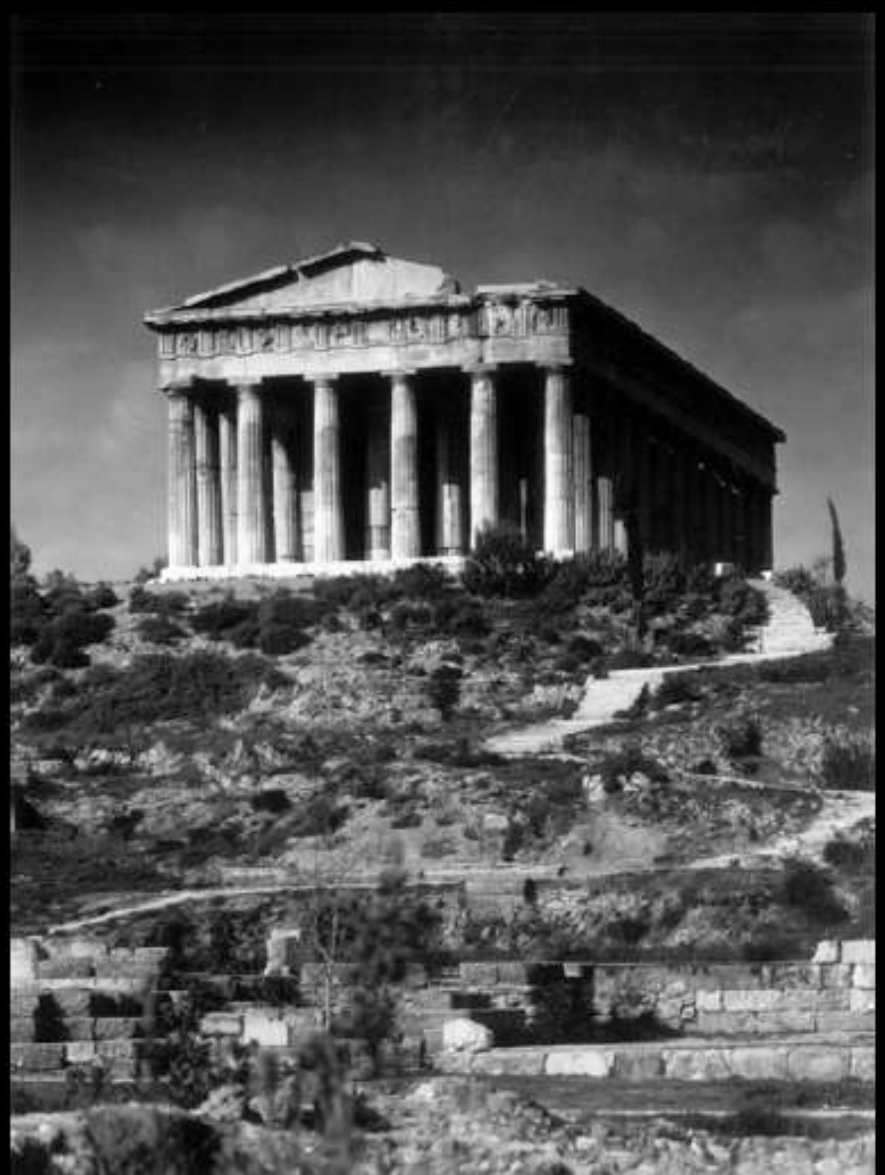
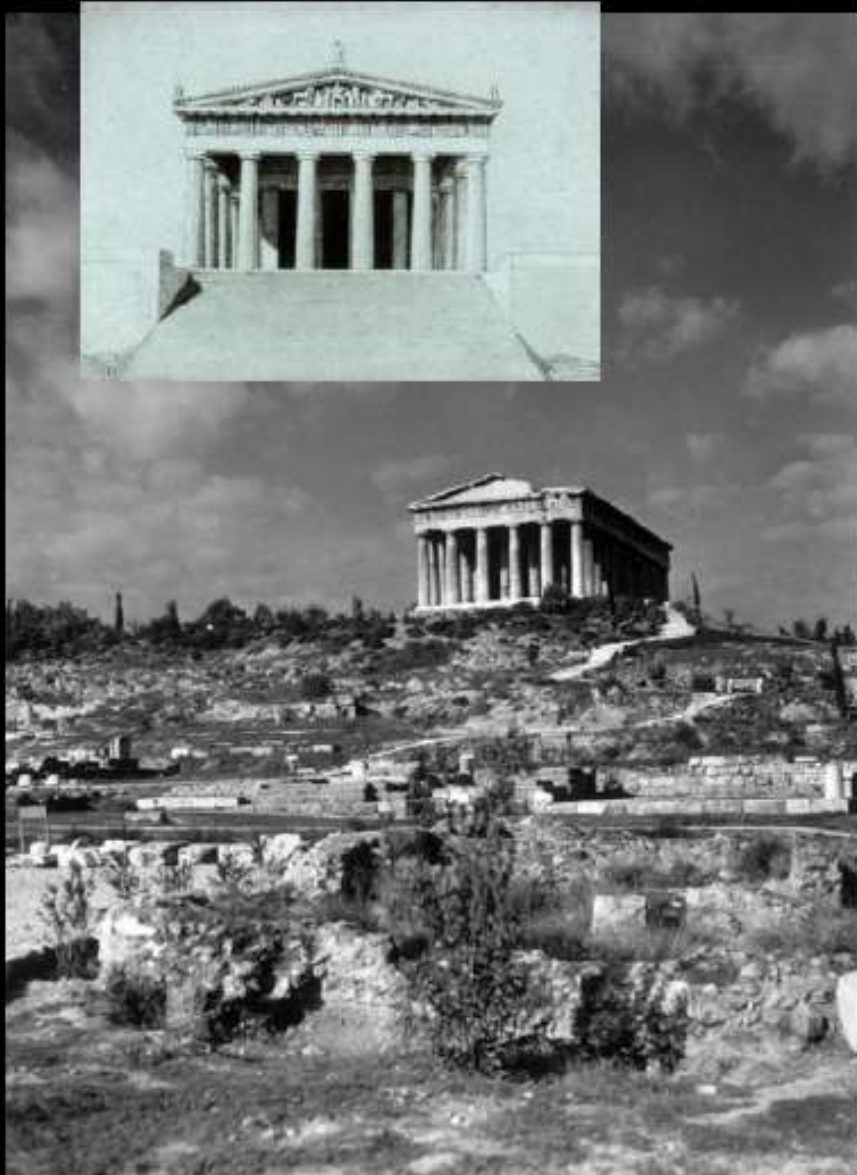

L'altare dei 12 Dei

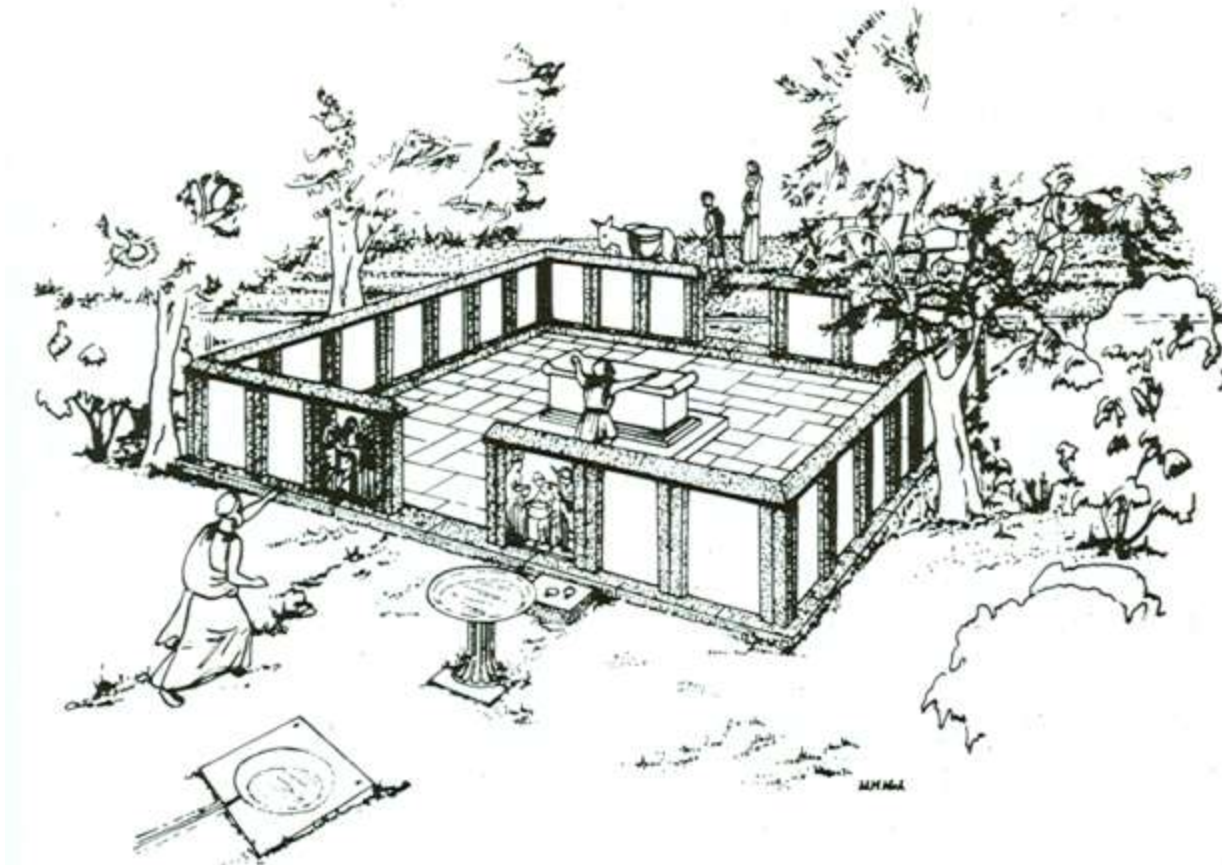

Lato occidentale: *stoa basileios*

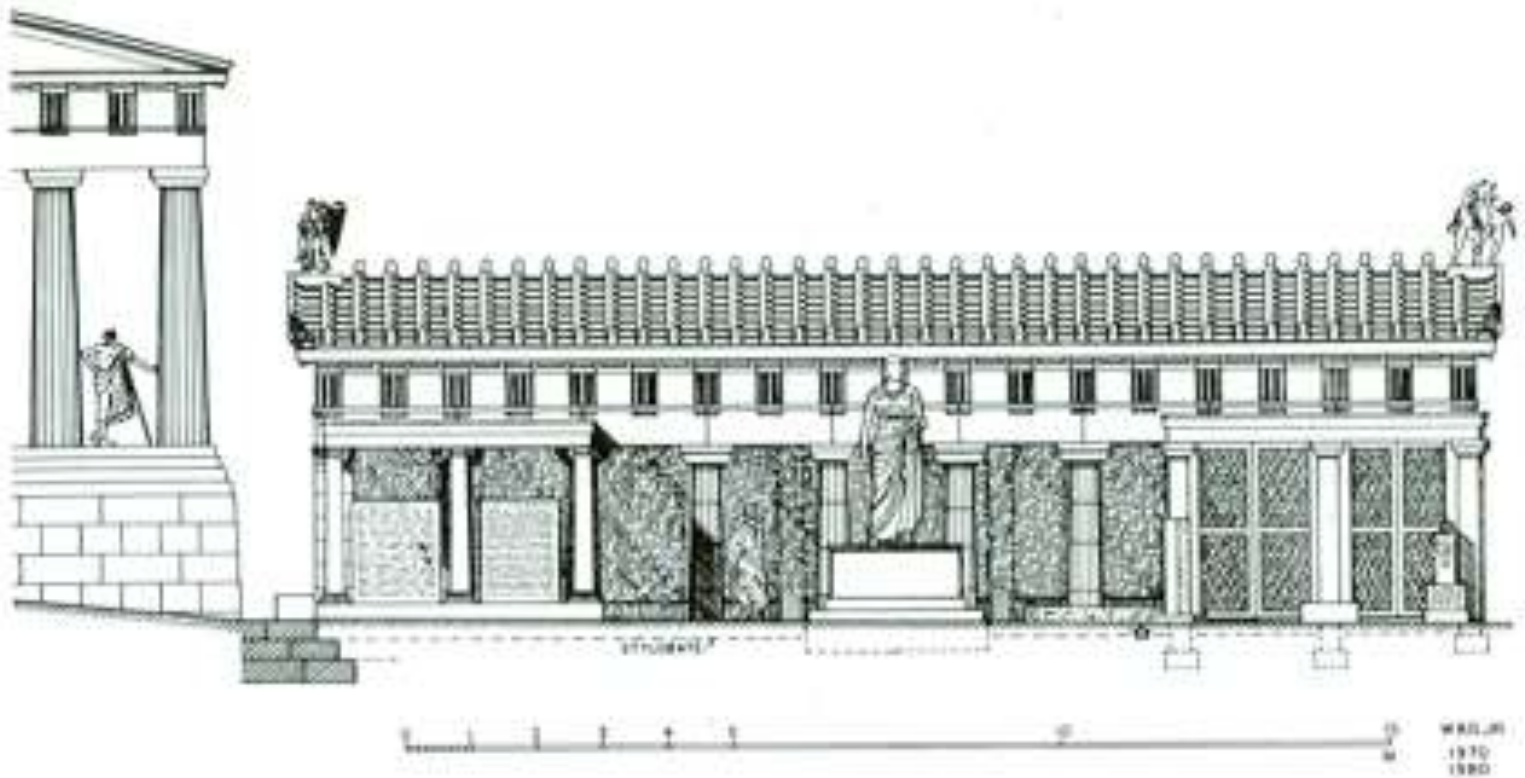

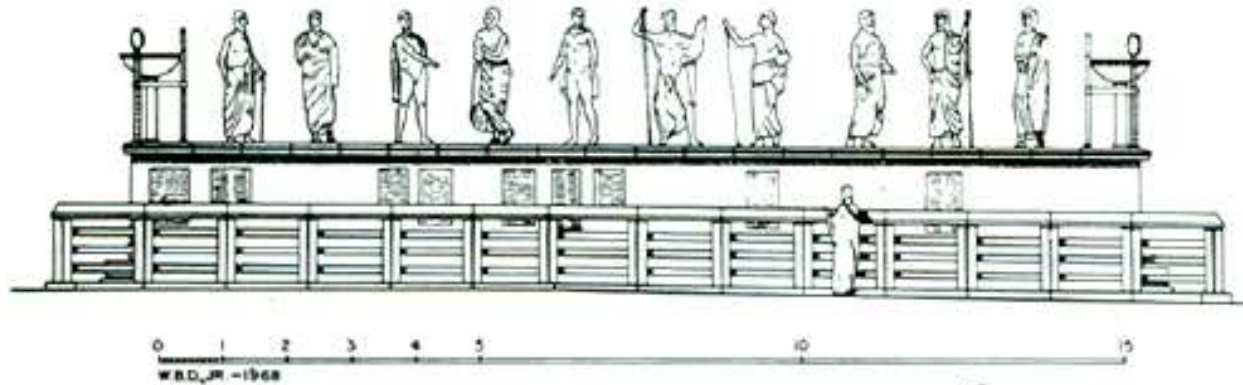
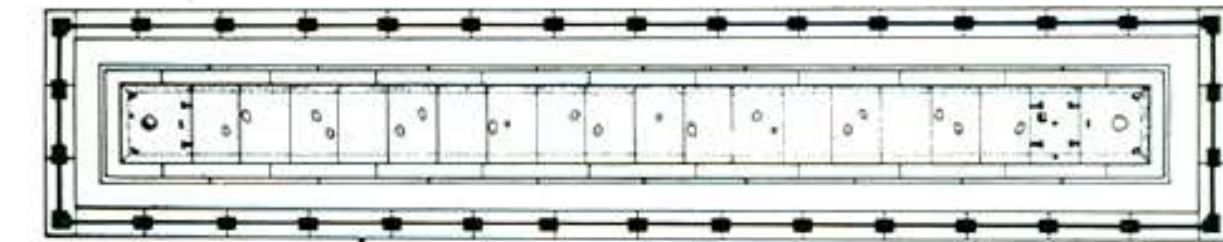

Atene, l'agorà del
Ceramico: il lato
occidentale, il
monumento degli eroi
eponimi

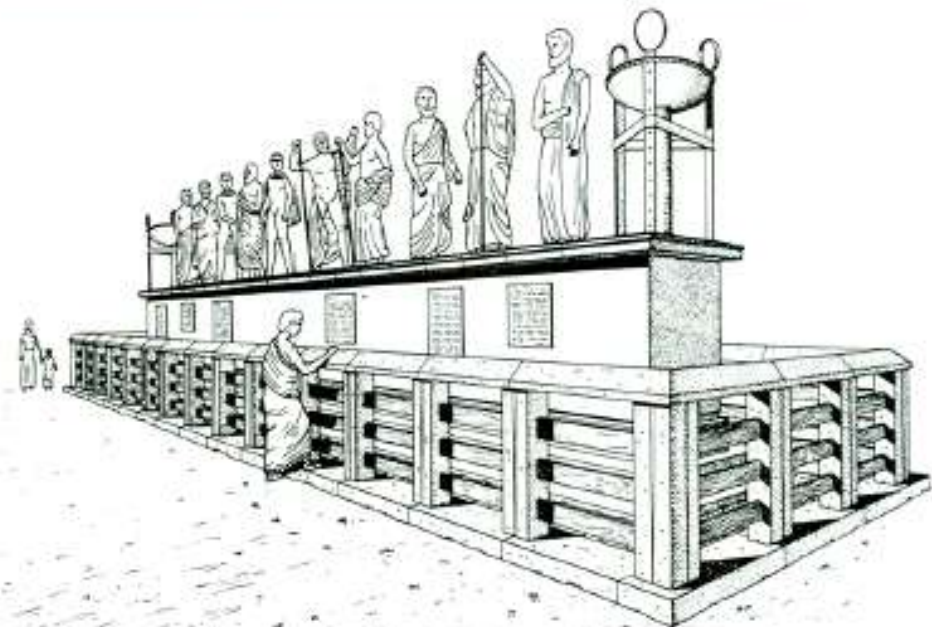

Atene, agorà del Ceramico,
stoà di Zeus Eleutherios, in
alto acroterio e in basso
prospetto

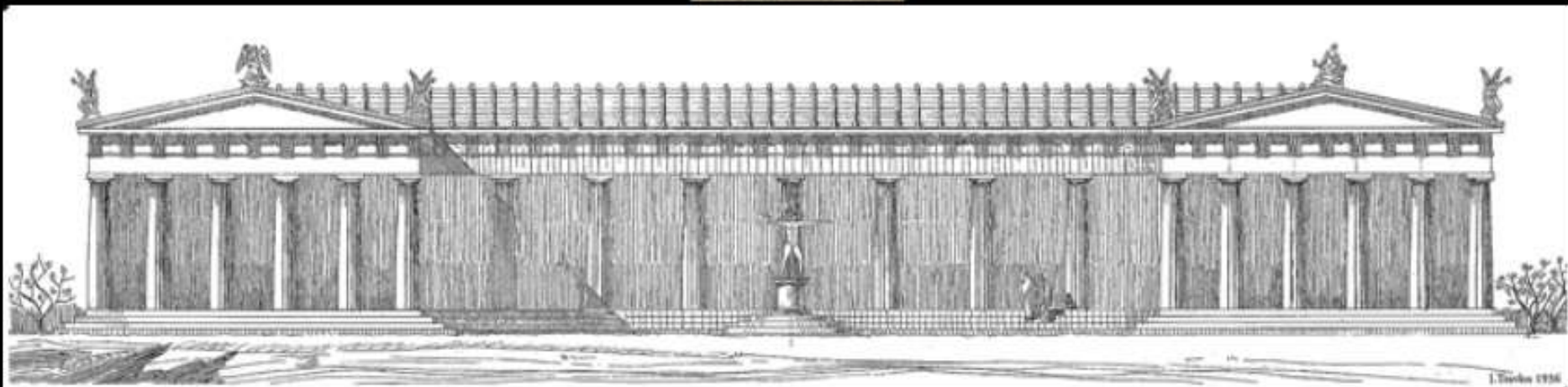

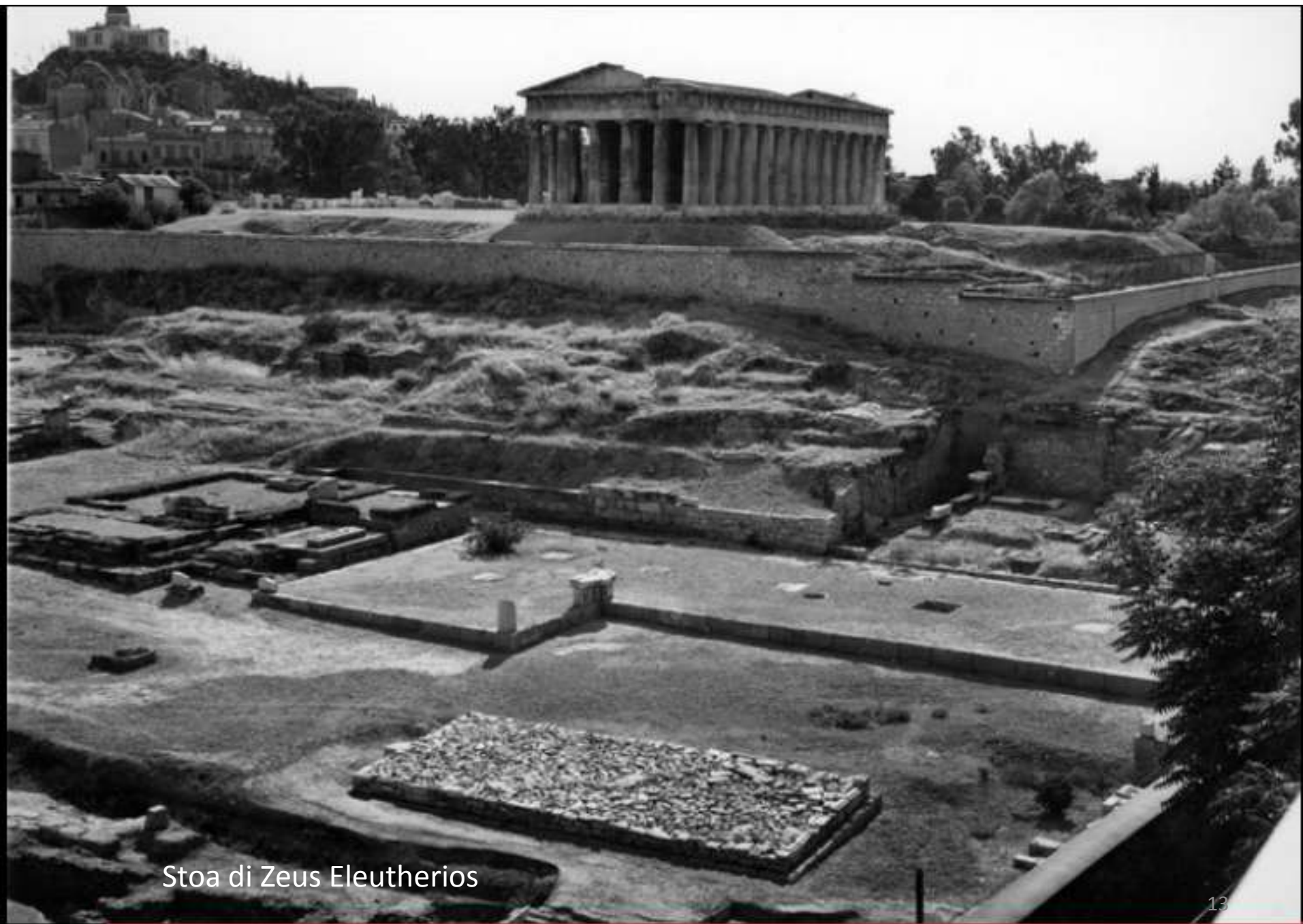

Stoa di Zeus Eleutherios